

- IEC60950 Compatible
- High insulation type High efficiency
- ROHS Compliance Product
- Operating Temperature range: 0°C TO +70°C

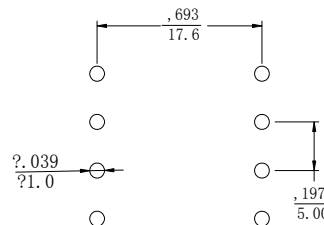

Electrical Specifications @ 25°C					
P/N	T/R	OCL @ 10KHz 0.1V	LL @ 100KHz 0.1V	DCR	HI-POT
MP1264Q	(3-4) : (1-2):(8-6)	(3-4)	(3-4),(tie2+6+8)	(3-4)	PRI TO SEC
	8.07:1:1.6	1.524mH ±10%	45.7μH MAX	1.6Ω MAX	3000VAC, 2mA, 3s

DIMENSIONS (unit: inch/mm):

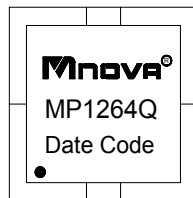

PCB LAYOUT

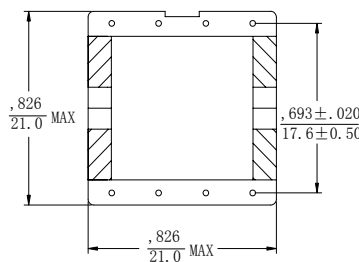
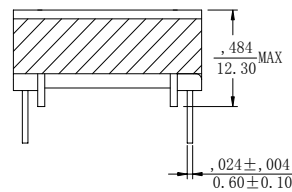
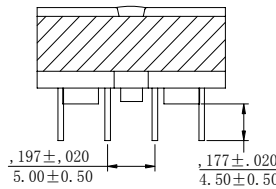

SCHEMATICS:

