

- Large Current and Low DCR
- Magnetically shielded construction
- High frequency range up to 1.0 MHz.
- Low noise.
- Ultra low cost.
- Operating Temperature range: -55°C TO +125°C



Electrical Specifications @ 25°C

P/N	100KHz 0.25V	D.C.R (mΩ)		Heat Rating Current	Saturation Current
	L0(μH) ±20% @0A	Typical	Max	Idc (Amp) Typical	Isat (Amp) Typical
MDM 0420-R10 M-S	0.1	3.5	4.0	12	22
MDM 0420-R22 M-S	0.22	6.0	6.6	9	12.5
MDM 0420-R47 M-S	0.47	13	14	8	10
MDM 0420-R56 M-S	0.56	14	16	8	10
MDM 0420-R68 M-S	0.68	18	20	7	9
MDM 0420-1R0 M-S	1.0	24	27	4.5	7
MDM 0420-1R5 M-S	1.5	37	42	5	6
MDM 0420-2R2 M-S	2.2	52	57	3.5	6
MDM 0420-3R3 M-S	3.3	74	87	3	4
MDM 0420-4R7 M-S	4.7	103	115	3	4
MDM 0420-6R8 M-S	6.8	110	123	2.5	3.5
MDM 0420-8R2 M-S	8.2	200	216	2	2
MDM 0420-100 M-S	10	205	230	2	2

Dimensions (unit: inch/mm)

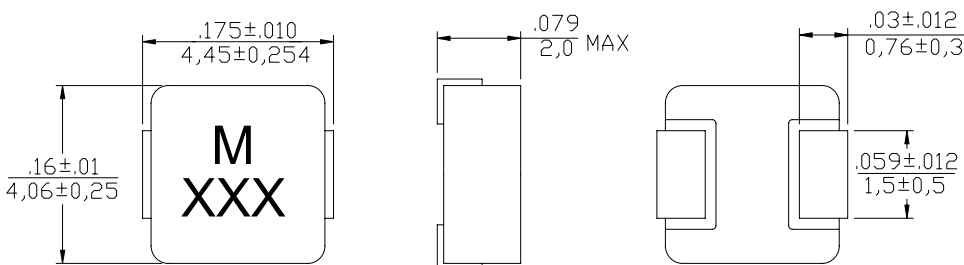

Recommended Layout: [unit: inch/ mm]

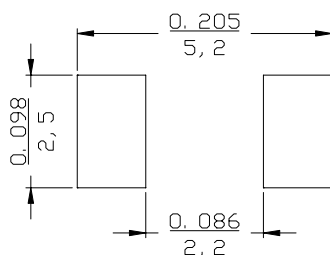

Schematics(continued)

