

### 1.GENERAL SPECIFICATION:

PART NUMBER: MS2067

SPECIFICATION: SINGE PORT 2.5G TRANSFORMER

POE APPLICATIONS CABLE SIDE DATA PAIRS CAPABLE OF 600mA DC .

STORAGE TEMP RANGE: -20°C TO +125°C

OPERATING TEMP RANGE: 0°C TO +70°C

PACKAGE: 24PIN SMD

IR TEMP: 260°C MAX

### 2.DIMENSIONS (unit:inch/mm):

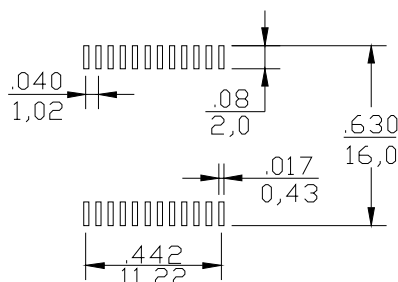
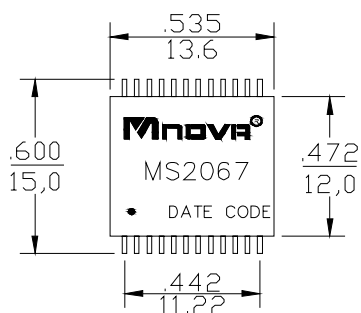

recommend PAD layout

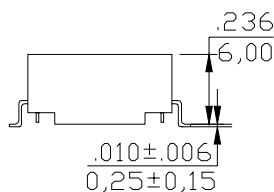
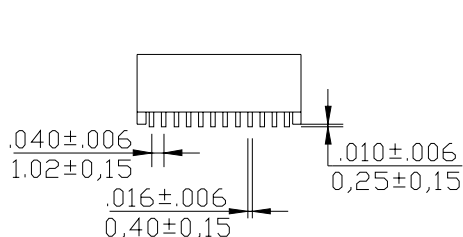

Note:Unless otherwise specified,all tolerances are:±  $\frac{.012}{0,30}$

### 3. SCHEMATIC:

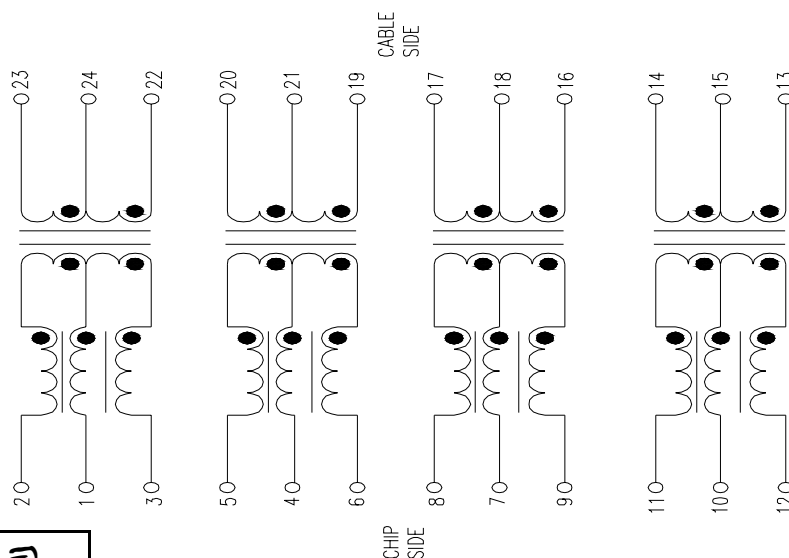

诺威实业有限公司  
MNOVA INDUSTRIAL CO.,LTD

|                    |                      |                       |
|--------------------|----------------------|-----------------------|
| 编号 PART NO: MS2067 | 名称 NAME: TRANSFORMER | 页号 PAGE: 1 OF 2       |
| 制表 SCHEDULER: SW   | 审核 CHECKER: WM       | 确认 CONFIRMING BY: ROY |
| 日期 DATE: 2016-8-16 | 日期 DATE: 2016-8-16   | 日期 DATE: 2016-8-16    |

4.ELECTRICAL SPECIFICATIONS @25°C:

4.1 HI-POT: PRI TO SEC =1500V AC 1mA 6S

4.2 T/R:100KHz 0.1V

1CT: 1CT±2%

4.3 OCL:

150μH MIN 100KHZ 100mV 10.2mA DC BIAS.

4.4 DCR:1.2 Ω MAX 25°C

4.5 LL:0.5μH MAX 100KHZ 100mV

4.6 IL: -0.5dB MAX @ 1-50MHZ

-1.0dB MAX @ 50-125MHZ

4.7 RL: -20dB MIN@1-40MHZ

-20+15\*log<sub>10</sub>(f/40)dB MIN@40~200MHZ

4.8 CMRR: -30dB MIN@30~200MHZ

4.9 CT: -30dB MIN@1~125MHZ

诺威实业有限公司  
MNOVA INDUSTRIAL CO.,LTD

|                    |                      |                       |
|--------------------|----------------------|-----------------------|
| 编号 PART NO: MS2067 | 名称 NAME: TRANSFORMER | 页号 PAGE: 2 OF 2       |
| 制表 SCHEDULER: SW   | 审核 CHECKER: WM       | 确认 CONFIRMING BY: ROY |
| 日期 DATE: 2016-8-16 | 日期 DATE: 2016-8-16   | 日期 DATE: 2016-8-16    |